

AL01008JD

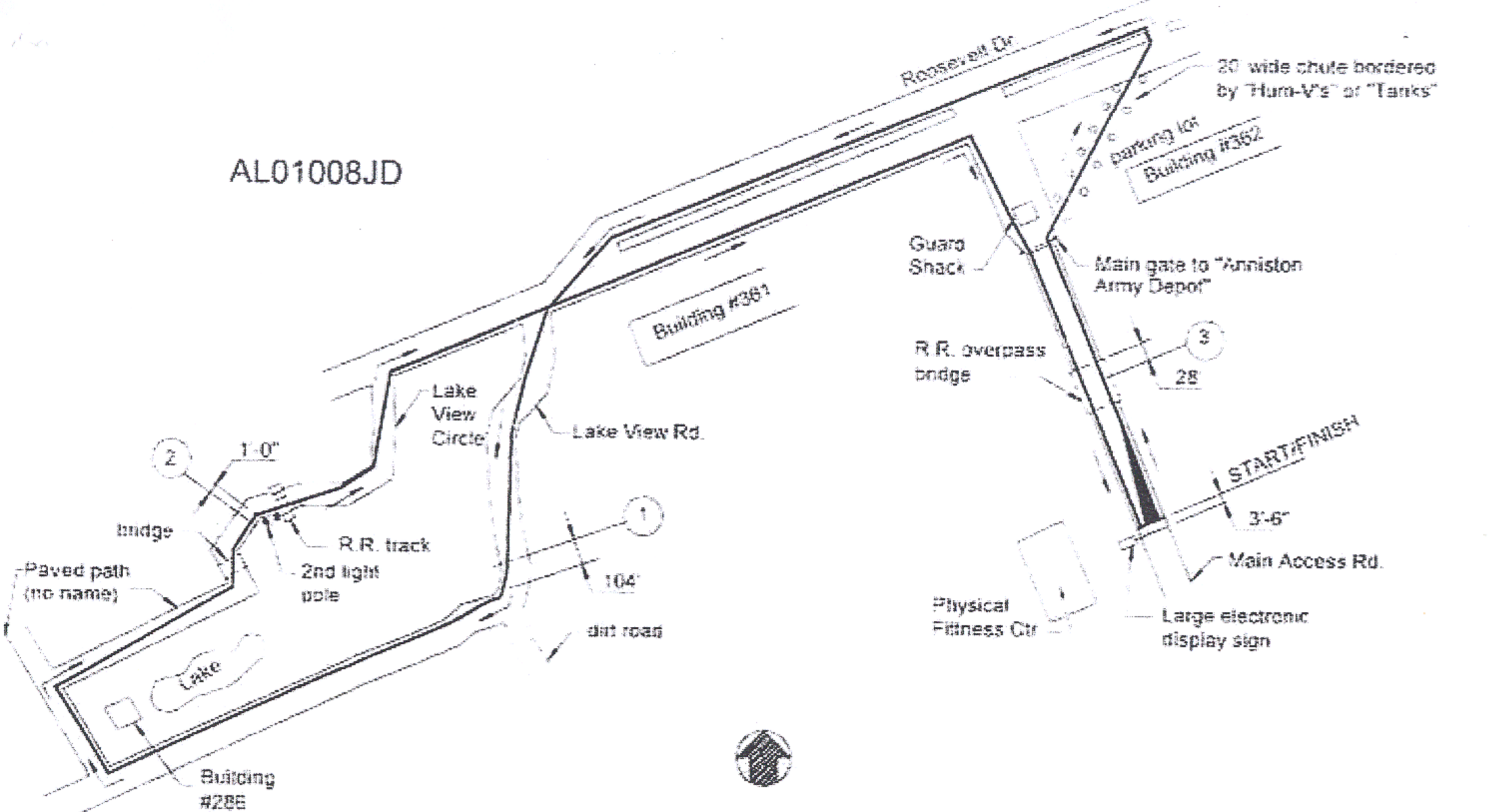

MAKING TRACKS 5K

ANNISTON, ALABAMA
(MAP NOT TO SCALE)

MEASURED BY: RICK MELANSON
1235 PARLIAMENT LN.
BIRMINGHAM, AL 35216 (205-979-1731)

ON 3-15-01 USING CAL COURSE #AL97012.ID

RACE DIRECTOR: RALPH USREY
ANNISTON ARMY DEPOT
7 FRANKFORD AVE.
ANNISTON, AL 36201
(256)820-4790

COURSE DESCRIPTION

Race begins on Main Access Rd. in front of the "Anniston Army Depot" Physical Fitness Ctr. and runs through the main gate and immediately cuts diagonally across the parking lot at Building #362 to the center median cross over on Roosevelt Dr. turns left and runs past Building #361 and turns left onto Lake View Rd. and continues past Lake and turns right on unnamed paved path behind Building #286 and then turns right on 1st unnamed paved path and runs to small bridge and runs to Lake View Circle and continues back to Roosevelt Dr. turns right and runs to Main Access Rd. turns right and runs back through Main Main Gate to Start/Finish line in front of Physical Fitness Center